

Performance Table

Unit	Item	Model							
		J35AD			J35AD				
		15H			30H				
Injection Unit	Screw cylinder type	K	A	B	K	A	B		
	Screw diameter	in	0.63	0.71	0.79	0.79	0.87	0.98	
	Screw stroke	in	2.362			3.150			
	Theoretical injection capacity	in ³	0.73	0.92	1.10	1.53	1.83	2.38	
	Standard	Injection capacity (GP-PS)	oz	0.4	0.5	0.6	0.9	1.0	1.3
		Injection pressure (Max.)	psi	40030	31620	25670	39160	32340	24950
		Holding pressure (Max.)	psi	36400	28720	23350	35530	29440	22770
		Injection speed	in/s	13.78			13.78		
		Injection rate	in ³ /s	4.3	5.5	6.8	6.8	8.2	10.4
		Plasticizing rate (GP-PS)	oz/s	0.10	0.14	0.17	0.17	0.21	0.27
		Screw speed	rpm	500			500		
		High speed (HS)	Injection pressure (Max.)	psi	40030	31620	25670	39160	32340
	Holding pressure (Max.)		psi	36400	28720	23350	35530	29440	22770
	Injection speed		in/s	21.65			21.65		
	Injection rate		in ³ /s	6.7	8.6	10.6	10.6	12.9	16.3
	Plasticizing rate (GP-PS)		oz/s	0.10	0.14	0.17	0.17	0.21	0.27
	Ultra speed (US)	Screw speed	rpm	500			500		
		Injection pressure (Max.)	psi	40030	31620	25670	39160	32340	24950
		Holding pressure (Max.)	psi	36400	28720	23350	35530	29440	22770
		Injection speed	in/s	31.50			31.50		
		Injection rate	in ³ /s	9.7	12.3	14.7	15.3	18.3	23.8
	Clamping Unit	Plasticizing rate (GP-PS)	oz/s	0.10	0.14	0.17	0.17	0.21	0.27
		Screw speed	rpm	500			500		
		Nozzle touch force	U.S. ton	1.11			1.66		
		Nozzle stroke from platen	in	2.0					
		Type of nozzle		Open nozzle					
		Cylinder temperature control		Cylinder 3 / Nozzle 2					
Heater wattage		kW	3.1			3.9			
Mechanism			Double toggle						
Clamping force		U.S. ton	38.7						
Daylight opening (Max.)		in	22.05						
General	Opening stroke (Max.)	in	9.06						
	Mold height	in	5.906~12.992						
	Distance between tie-bars (H×V)	in	12.20×11.42						
	Platen size (H×V)	in	17.72×16.93						
	Ejector point		3 points						
	Ejector force	U.S. ton	1.11						
	Ejector stroke	in	1.969						
General	Machine weight	U.S. ton	2.8			2.9			
	Machine dimensions (L×W×H)	ft	10.53×3.31×5.18			10.60×3.31×5.18			

Remarks:

- Maximum injection pressure and maximum holding pressure may be restricted due to molding condition.
- The theoretical injection capacity is (cross sectional area of cylinder) × (stroke of screw).
- The injection capacity is applicable for GP-PS and variable according to the grade of resin, molding conditions and mold.
- The plasticizing rate is applicable for GP-PS.
- PC, HPVC, other engineering plastic, etc., low temperature setting and high speed molding may require a high torque depending on the grade or molding conditions. Please contact us if you plan.

Note:

- Due to continual improvements, specifications are subject to change without notice.
- Actual figures of the specification will vary depending on final machine configuration. Please contact us if you require more specific data.
- Performance specifications are based on theoretical data.
- High speed injection and Ultra speed injection are optional.

Equipment Dimensions and Mold Related Dimensions

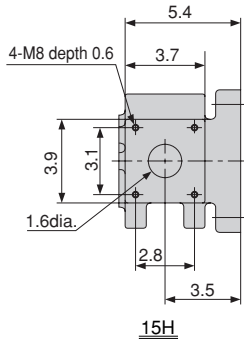
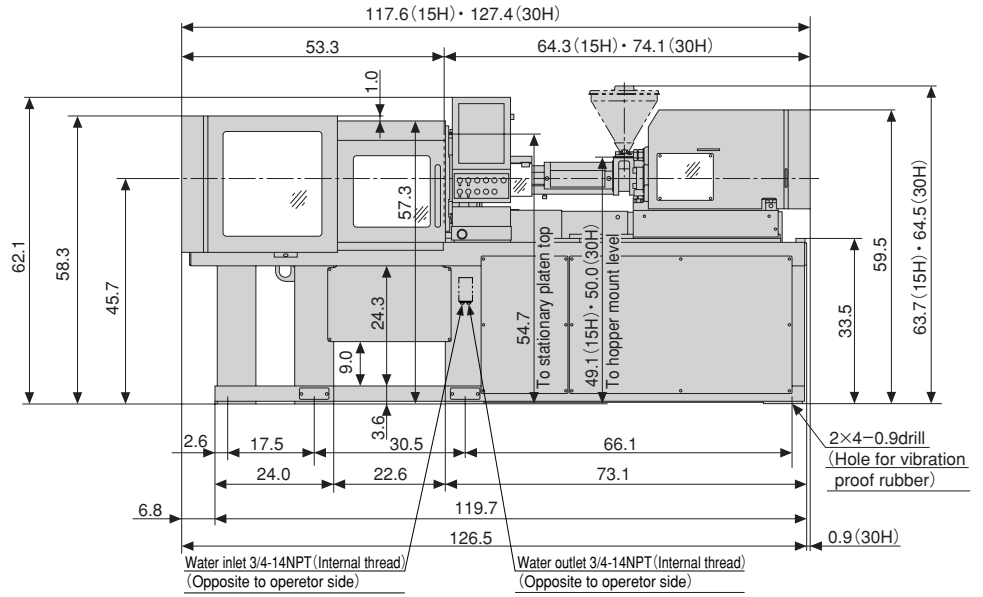
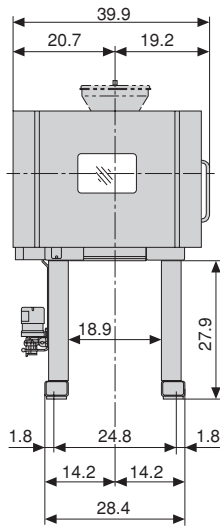

15H

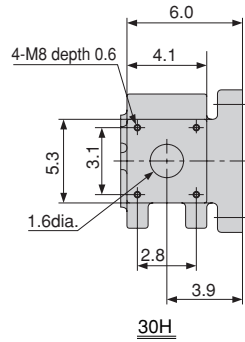

30H

Hopper mount

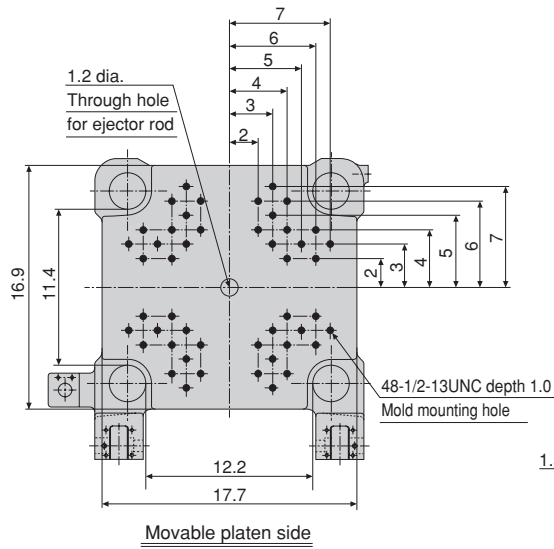
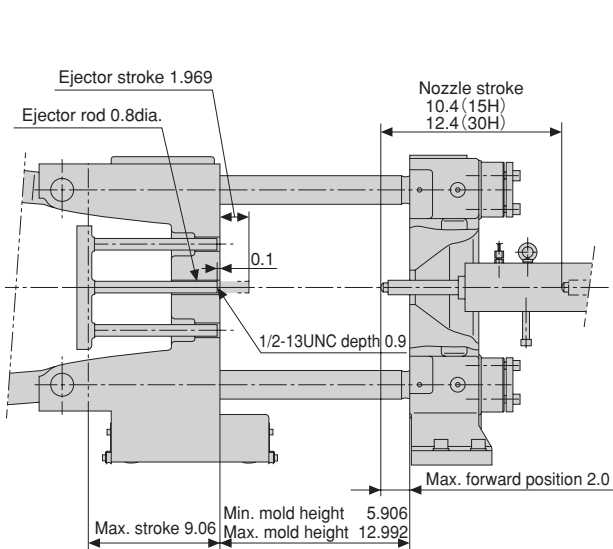
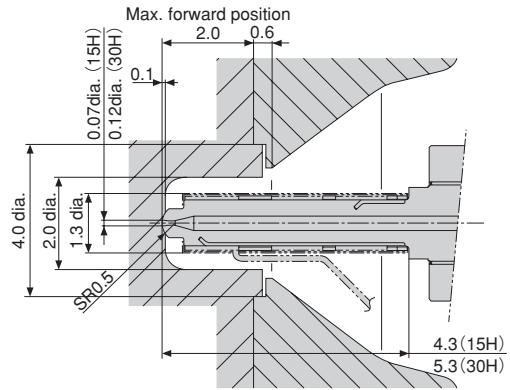

Movable platen side

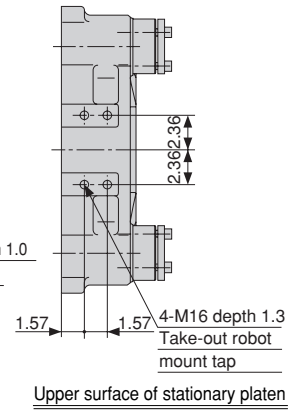

Upper surface of stationary platen