

Performance Table

Unit	Model	J140AD								
		60H			110H			180H		
Item										
Screw cylinder type		K	A	B	K	A	B	K	A	B
Screw diameter	mm	25	28	32	32	35	40	35	40	45
Screw stroke	mm	100			120			140		
Theoretical injection capacity	cm ³	49	62	80	97	115	151	135	176	223
Injection capacity (GP-PS)	g	45	56	73	88	105	137	123	160	203
Standard	Injection pressure(Max.) MPa {kgf/cm ² }	270 {2750}	215 {2190}	165 {1680}	270 {2750}	225 {2290}	172 {1750}	260 {2650}	199 {2020}	157 {1600}
	Holding pressure(Max.) MPa {kgf/cm ² }	245 {2490}	195 {1980}	150 {1530}	245 {2490}	205 {2090}	157 {1600}	236 {2400}	181 {1840}	143 {1450}
	Injection speed	350			350			350		
	Injection rate	172	216	281	281	337	440	337	440	557
	Plasticizing rate (GP-PS) kg/h	34	46	74	74	92	123	92	127	166
	Screw speed	400			400			400		
	Injection Unit High speed (HS)	Injection pressure(Max.) MPa {kgf/cm ² }	270 {2750}	215 {2190}	165 {1680}	—	—	—	—	—
Holding pressure(Max.) MPa {kgf/cm ² }		245 {2490}	195 {1980}	150 {1530}	—	—	—	—	—	—
Injection speed		500			—			—		
Injection rate		245	308	402	—	—	—	—	—	—
Plasticizing rate (GP-PS) kg/h		34	46	74	—	—	—	—	—	—
Injection Unit Ultra speed (US)	Injection pressure(Max.) MPa {kgf/cm ² }	270 {2750}	215 {2190}	165 {1680}	—	—	—	—	—	—
	Holding pressure(Max.) MPa {kgf/cm ² }	245 {2490}	195 {1980}	150 {1530}	—	—	—	—	—	—
	Injection speed	800			—			—		
	Injection rate	393	493	643	—	—	—	—	—	—
	Plasticizing rate (GP-PS) kg/h	34	46	74	—	—	—	—	—	—
Screw speed	400			—			—			
Nozzle touch force	kN {tf}	14.8 {1.5}			19.7 {2.0}			19.7 {2.0}		
Nozzle stroke from platen	mm	50								
Type of nozzle		Open nozzle								
Cylinder temperature control		Cylinder 4 / Nozzle 2								
Heater wattage	kW	5.5			9.2			10.2		
Clamping Unit	Mechanism	Double toggle								
	Clamping force	1370 {140}								
	Daylight opening (Max.)	850								
	Opening stroke (Max.)	400								
	Mold height	200~450								
	Distance between tie-bars (H×V)	530×460								
	Platen size (H×V)	780×660								
	Ejector point	5 points								
Ejector force	32.4 {3.3}									
Ejector stroke	100									
General	Machine weight	6.3			6.4			6.5		
	Machine dimensions (L×W×H) m	4.77×1.26×1.79			4.91×1.26×1.79			4.98×1.26×1.79		

Remarks:

1. Maximum injection pressure and maximum holding pressure may be restricted due to molding condition.
2. The theoretical injection capacity is (cross sectional area of cylinder) × (stroke of screw).
3. The injection capacity is applicable for GP-PS and variable according to the grade of resin, molding conditions and mold.
4. The plasticizing rate is applicable for GP-PS.
5. PC, HPVC, other engineering plastic, etc., low temperature setting and high speed molding may require a high torque depending on the grade or molding conditions. Please contact us if you plan.

Note:

1. Due to continual improvements, specifications are subject to change without notice.
2. Actual figures of the specification will vary depending on final machine configuration. Please contact us if you require more specific data.
3. Performance specifications are based on theoretical data.
4. High speed injection and Ultra speed injection are optional.
5. 1MPa=10.2 kgf/cm², 1kN=0.102tf

Equipment Dimensions and Mold Related Dimensions

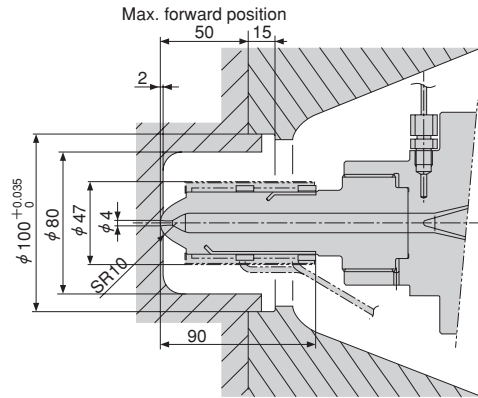
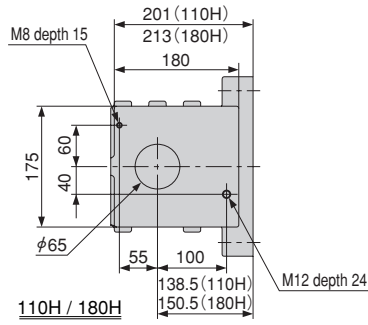
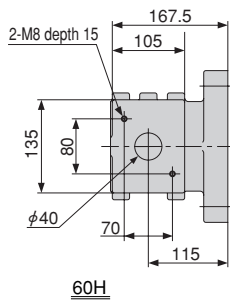
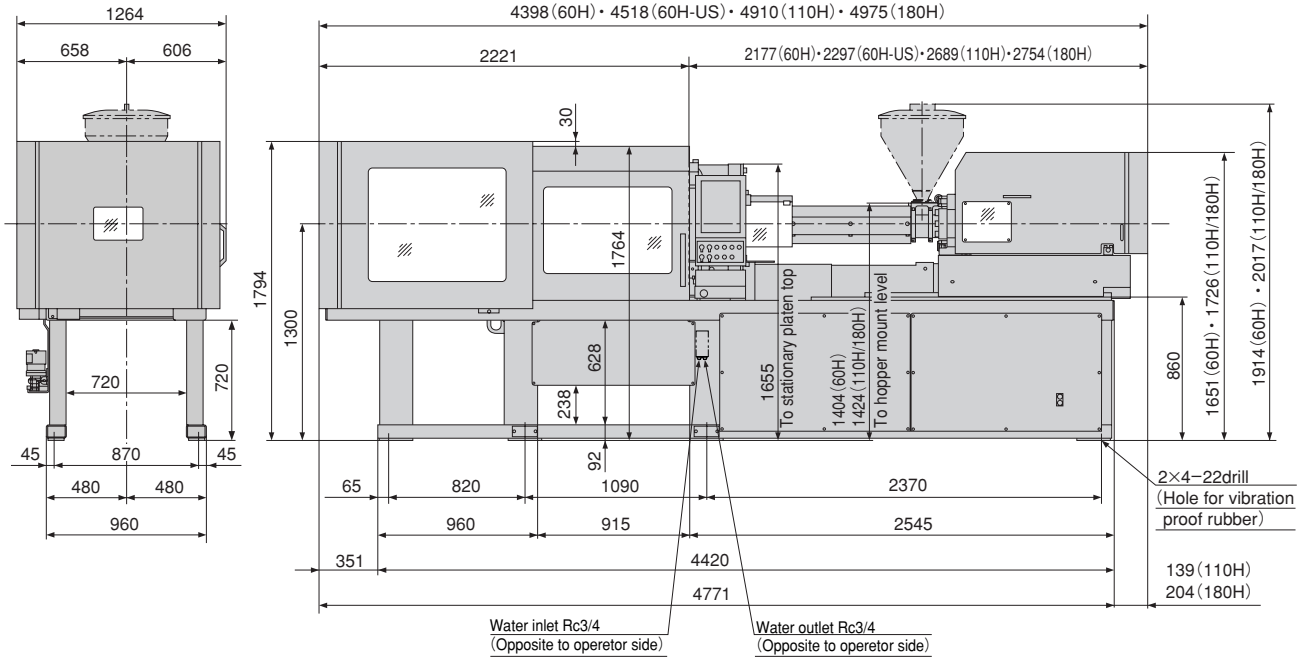

Hopper mount

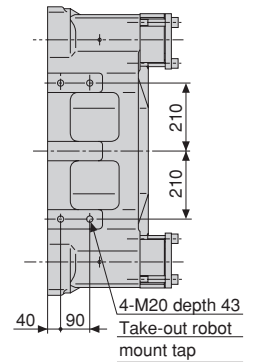
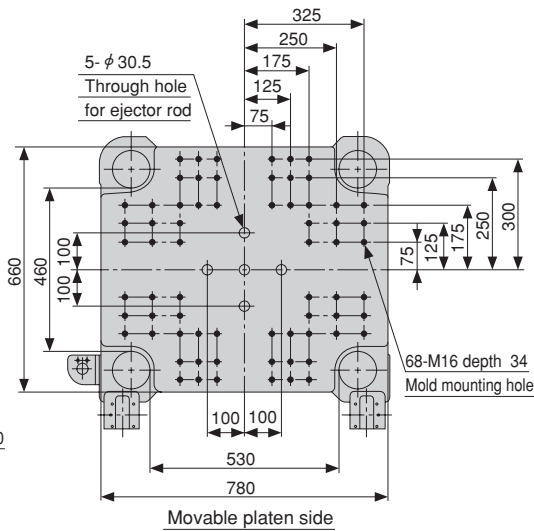
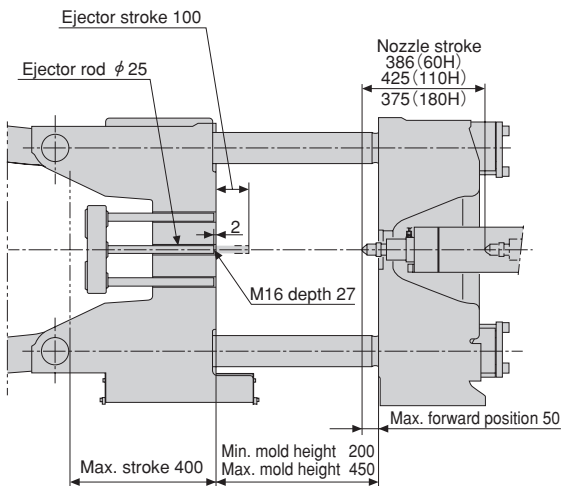

Upper surface of stationary platen